

LD Flexi

IP68 Flexible 24V Linear LED



Data sheet - Page 1



LD Flexi is a robust, very shallow, IP68 rated flexible 24V linear LED product. Ideal for a range of architectural applications such as step details. LD Flexi is not intended for permanent underwater use.

Please note colour shift: Due to the resin being in contact with the LED there is a colour shift of around 600K to a cooler white colour temperature. This means the warmest white we can supply is 3000K which uses 2400K LED tape (Shortpitch only).

Key Features

- Choice of LED outputs depending on the application, including RGB
- Specially designed PVC extrusion which is robust but very flexible with excellent resistance to chemical attack
- LEDs are encapsulated in an optically clear UV resistant polyurethane resin
- Fixing is by stainless steel fixing clips, with a choice of two depending on the installation detail
- LD Flexi only bends in the vertical plane (around the thinnest side), to a minimum bend radius of 200mm
- Lengths are custom made to suit to a maximum of 3015mm**
- Available with Switched, 1-10V, DMX or Dali drivers

Dimensions

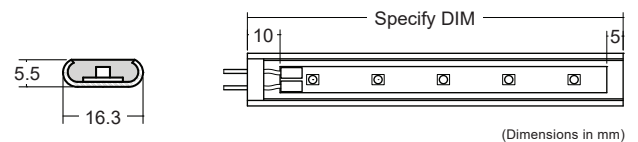

LD Flexi



IP68 Flexible 24V Linear LED

Data sheet - Page 2

LED output options	LG500 500 lm/m		Short 800 lm/m		RGB ECO 180 lm/m
Applications					
	<p>Highlighting architectural details, steps</p>		<p>Same applications as LG500 but with increased output and closer pitch LEDs</p>		<p>Colour change</p>
Description	500lm tape		Short pitch tape		RGB tape
Colour Temperature*	2800K (2200K)* / 3100K (2500K)* / 3300K (2700K)*	3600K (3000K)* / 4600K (4000K)*	3000K (2400K)* / 3300K (2700K)* / 3600K (3000K)*	4600K (4000K)* / 5600K (5000K)*	-
CRI	80+				-
Delivered lumens / m	480lm/m	520lm/m	800lm/m	850lm/m	180lm/m
Watts / m	3.9W/m		8.7W/m		6.5W/m
Lumens per watt	128lm/w		92lm/w	98lm/w	-
LED cut increments	100mm		50mm		150mm
LED spacing	14.3mm		8.3mm		30mm
Min single length	115mm		65mm		166mm
Max single length**	3015mm		3015mm		3016mm
LED	Osram Flex				
Voltage (V)	24V DC				
LED lifetime	50,000hrs (to 70% lumen output)				
Max ambient temperature	45°C				30°C
Minimum bend radius	200mm				
Materials	LD Flexi - PVC extrusion, polyurethane resin, polycarbonate end cap. Fixing clips - stainless steel.				
Cable length	2m (can be specified with up to 10m at extra cost)				
IP rating	IP68 - Not for permanent submersion				

* Resin used within the LD Flexi causes a 600K shift. Bracketed temperature indicates reading before colour shift.

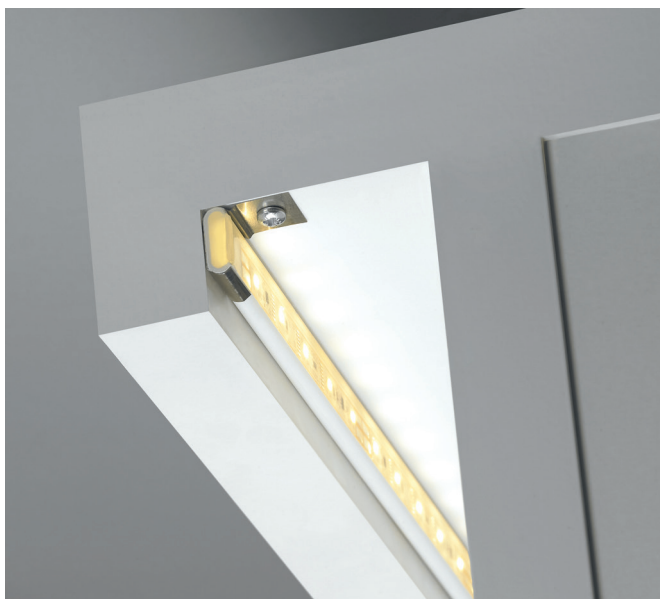

Fixing options

/FFC - Flat fixing clip

/AFC - Angled fixing clip

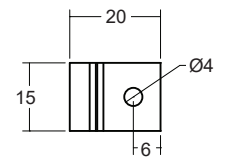
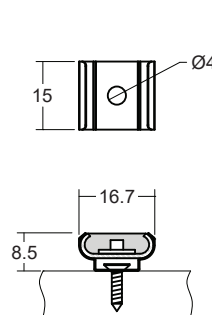

(Dimensions in mm)

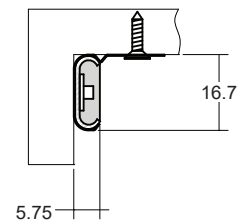

LD Flexi

IP68 Flexible 24V Linear LED



Data sheet - Page 3

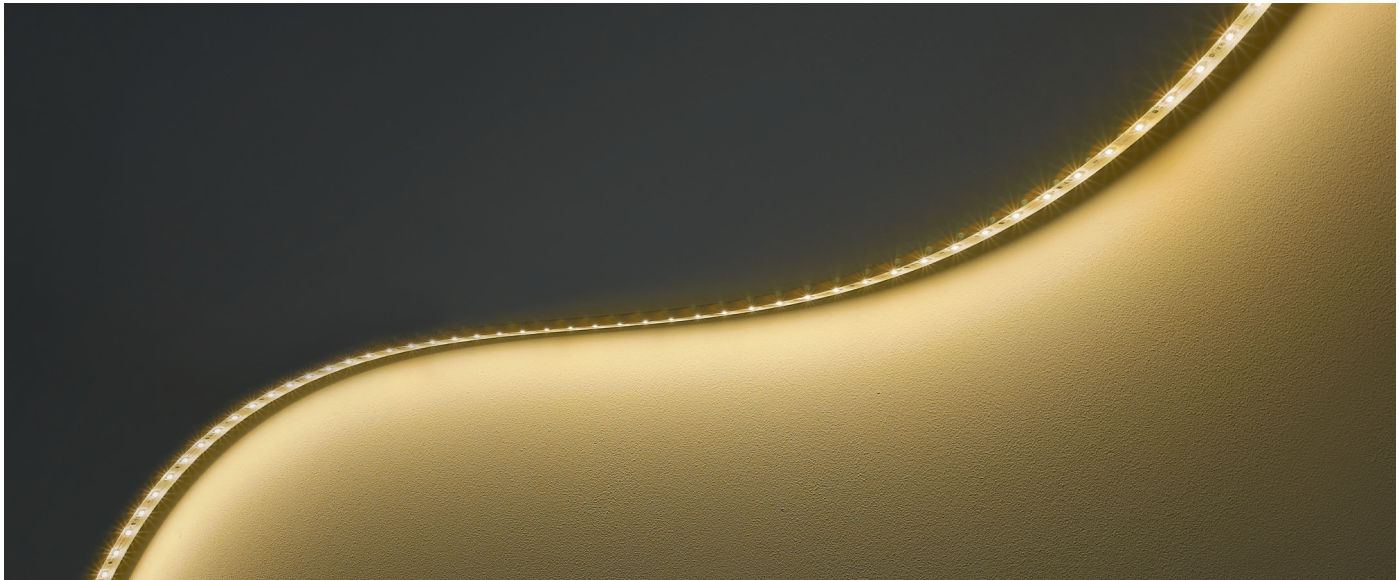

Suggested mounting details

We recommend the distances shown below when mounting multiple lengths end to end to ensure a continuous wash of light.

Angled fixing clip

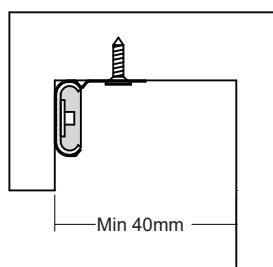

Flat fixing clip

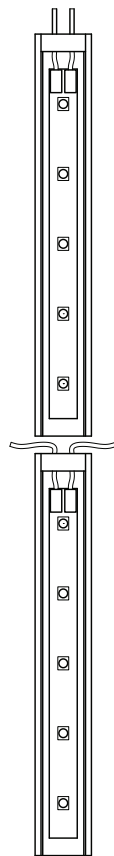
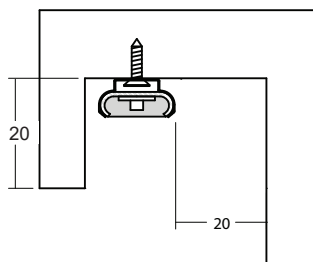

Photometrics

Photometric files are included in the design pack which can be downloaded from the LD Flexi product page on the website.

Order Codes and Options

Product code	LED	LED colour	Fixing option	Length
LD Flexi	<input type="text"/>	<input type="text"/>	<input type="text"/>	<input type="text"/>

Example: LDFlexi / Eco / LW33 / AFC / 2000mm

LED output options		Suffix
LG500	500 lm/m	/LG500
Short	800 lm/m	/Short
RGB Eco	180 lm/m	/RGB Eco

LED colour options		
LG500	Extra Warm White - 2800K	/LW28
	Warm White - 3100K	/LW31
	Warm White - 3300K	/LW33
	White - 3600K	/LW36
	Cool White - 4600K	/LW46
	Short	Warm White - 3000K
Warm White - 3300K		/LW33
White - 3600K		/LW36
Cool White - 4600K		/LW46
	Cool White - 5000K	/LW56

*Other LED colour temperatures are available. Please speak to a member of our sales team.

Fixing options

Angled fixing clip	/AFC
Flat fixing clip	/FFC

(3 fixing clips supplied per metre)

To be used with 24V constant voltage LED Drivers and Controllers

We offer a range of drivers with 1-10V, DMX, and DALI dimming options. Please download the data sheet from the downloads section at www.lightgraphix.co.uk, or contact us for more information